

LSAA

LIGHTWEIGHT STRUCTURES ASSOCIATION OF AUSTRALASIA INC.

2009 Design Awards

"Technology and Sustainability Applications in Lightweight Structures"



29-30th October 2009
The Arts Centre, Melbourne

LSAA 2009 Conference & Design Awards

"Technology and Sustainability Applications in Lightweight Structures"

The Lightweight Structures Association (LSAA) is an autonomous, inter-disciplinary group of interested parties involved in the field of lightweight structures with the basic aim of promoting the proper application of lightweight structures, their design, fabrication, construction and materials, and the development of these and other aspects particular to lightweight structures.

The LSAA is pleased to announce the entrants and winners of the LSAA Design Awards. The Awards will be presented during the Conference Dinner, 29th October 2009 at the Arts Centre, Melbourne. The two day conference will highlight the achievements of the industry in the global arena and examine new developments and local issues.

The Awards are in recognition of excellence in design, construction and application of Lightweight Structures.

Gold sponsor



Silver sponsor



Tensile solutions in cable & rod
Planning, Design, Implementation



Architectural Rigging Systems

Ronstan also specializes in tensile systems for:

- Lightweight architecture
- Structural Cable applications
- Structural Rod applications
- Cable Nets
- Balustrade Cables
- Greening Cables
- Facade Cables

Contact us for catalogues or further information

HEAD OFFICE

Australia - Victoria
Ronstan International Pty. Ltd.
220 Bay Road, Sandringham
Victoria 3191, Australia
Ph: +61 (0)3 8599 0000
Fax: +61 (0)3 8599 0099
Email: architectural@ronstan.com.au
Website: www.ronstan.com/arch

Creating emotions

Membranes by Mehler Technologies
bring alive architect's imagination



For more than 20 years architects, engineers and city planners trust in membranes by Mehler Technologies. The outstanding properties of these textile structure fabrics convince more than ever.

MEHLER
TECHNOLOGIES

www.mehler-technologies.com

Category 1: Small Structures



1022

Elements Wine Bar

Entrant: Structurflex Ltd
 Location: KCPL District - Kansas City Missouri USA
 Client: The Cordish Group
 Architect: 360 Architects
 Struct. Eng.: Wade Design Engineers & Wayne Rendely PE
 Builder: Structurflex
 Fabricator: Structurflex



1200

Penbank Sound Shell

Entrant: Structureflex Pacific
 Location: Penbank School, Moorooduc
 Client: Penbank School
 Struct. Eng.: John Killmister
 Builder: Shade Living
 Fabricator: Structureflex Pacific



1099

Amazon Waterlily Pavilion

Entrant: Aurecon - Adelaide - Designer / Consultant
 Location: Adelaide Botanical Gardens - Adelaide SA
 Client: Government of South Australia (DTEI)
 Architect: Flightpath Architects
 Struct. Eng.: Connell Wagner



1397

Monash University Building 76 Strip Facade Structures

Entrant: Oasis Tension Structures
 Location: Monash University, Clayton Vic
 Architect: DesignInc (Melbourne)
 Struct. Eng.: John Mullin & Partners
 Specialist: Tensys Engineering (Australia) Pty Ltd
 Others: Ronstan International (Australia) Pty Ltd
 Builder: Hooker Cockram Projects Ltd
 Fabricator: Atkins Fabrication (Australia) Pty Ltd

Category 1: Small Structures Cont.



Yatala Tank Cover

Entrant: MakMax Australia - Designer
Location: Fosters Australia - Cuthbert Road, Yatala
Client: Foster's Australia
Struct. Eng.: MakMax Australia
Builder: MakMax Australia
Fabricator: MakMax Australia



Aussie World Entrance Canopy

Entrant: Light Weight Structures Advisory Service
Location: Bruce Highway - Palmview
Client: Aussie World Theme Park
Struct. Eng.: Trevor Scott & Jeremy Hunter
Specialist: LTWSAS
Builder: Aussie World Project Management
Fabricator: Made 4 Shade

Category 2: Medium Structures



2022

Hamilton Lake - Verandah Cafe

Entrant: Structurflex Ltd
 Location: Hamilton Lake Domain
 Client: Hamilton City Council
 Architect: 360 Architects
 Struct. Eng.: CompuSoft Engineering
 Builder: Foster Construction
 Fabricator: Structurflex

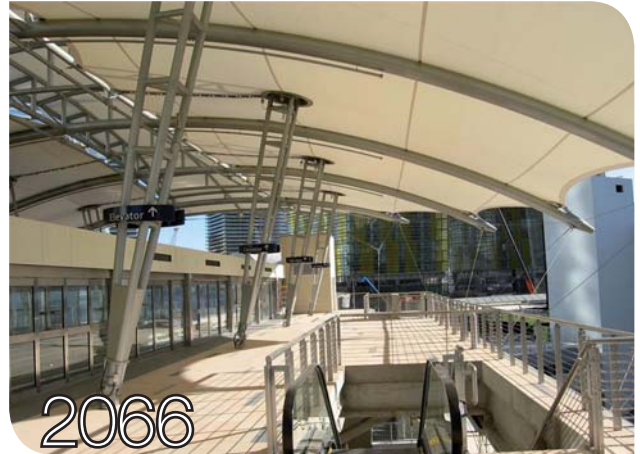

2066

CityCentre Automated People Mover

Entrant: Tensys Engineers Pty Ltd
 Location: Las Vegas, USA
 Client: MGM CityCentre.
 Architect: Gensler
 Struct. Eng.: Bouquet Structural Engineers, USA
 Specialist: Tensys Engineers
 Others: Fabritec Structures, USA
 Builder: Clark Thor Construction Group, USA
 Fabricator: Atkins Fabrication (Australia) Pty Ltd

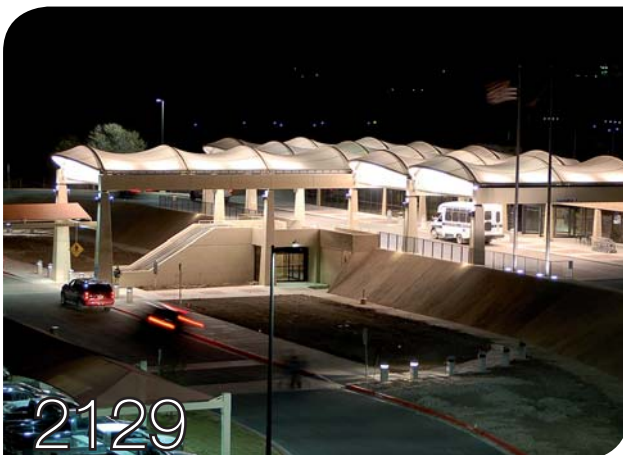

2129

Abilene Airport

Entrant: Atkins Fabrication (Aust) Pty Ltd - Fabricator
 Location: Abilene - Texas USA
 Client: USA Shade & Fabric Structures Inc.
 Fabricator: Atkins Fabrication (Australia) Pty Ltd



2397

Mildura Riverfront Performance Venue

Entrant: Oasis Tension Structures (Australia)
 Location: Hugh King Boulevard - Mildura VIC
 Client: City of Mildura Council
 Architect: Jackson Architecture (Melbourne)
 Struct. Eng.: Aurecon (Melbourne)
 Specialist: Tensys Engineering (Australia) Pty Ltd
 Others: A. Nobles & Sons (Australia) Pty Ltd
 Builder: King Construction Pty Ltd
 Fabricator: Atkins Fabrication (Australia) Pty Ltd

Category 2: Medium Structures Cont



2813

Point Boston Peninsular Club

Entrant: MakMax Australia - Designer
 Location: Port Lincoln South Australia
 Client: Kym Clarke Constructions
 Architect: John Diekman Architects
 Struct. Eng.: MakMax Australia
 Others: Cost Management Partners
 Builder: Kym Clarke Constructions
 Fabricator: MakMax Australia



2889

Biofilter at Surry Hills Library

Entrant: Taylor Thomson Whitting - Designer
 Location: Surry Hills NSW
 Client: City of Sydney Council
 Architect: Francis-Jones Morehen Thorp
 Struct. Eng.: Taylor Thomson Whitting
 Specialist: Mech Eng: Steenson Varming
 Others: Austress
 Builder: WBHO Probuild
 Fabricator: Austress

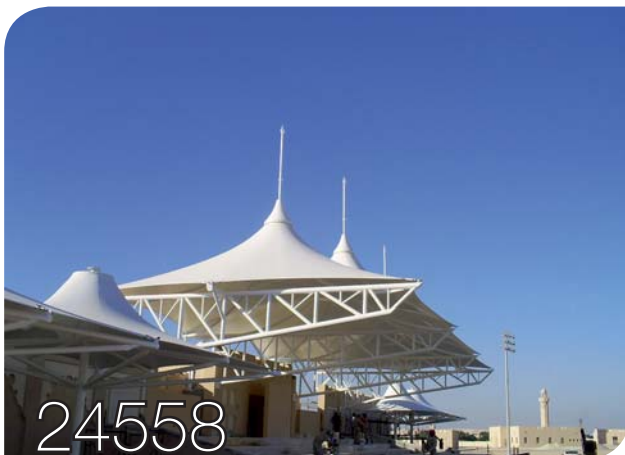

24558

Isa Royal Military College Grand Stand

Entrant: Light Weight Structures Advisory Service
 Location: Isa Royal Military College - Bahrain
 Client: Alasco Group & Al Alaa Shade Company
 Struct. Eng.: Trevor Scott & Jeremy Hunter
 Specialist: LTWSAS
 Builder & Fabricator: Al Alaa Shade Company

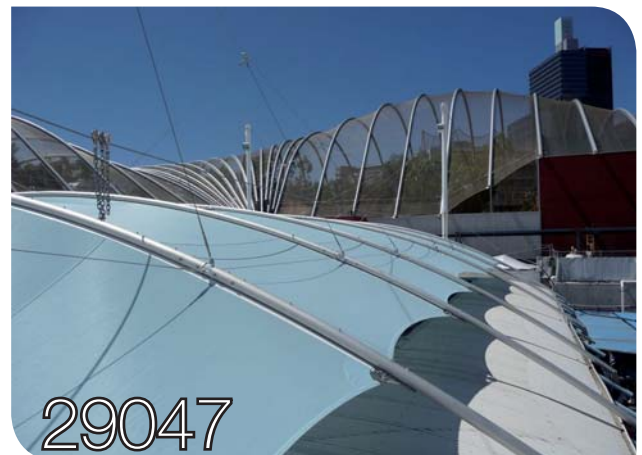

29047

Sydney Aquarium Dugong's at Mermaid Lagoon

Entrant: UFS Australasia Pty Ltd
 Location: Sydney Aquarium - Darling Harbour Sydney
 Client: Sydney Attractions Group
 Struct. Eng.: Wade Consulting
 Builder: Universal Fabric Structures / Ozrig
 Fabricator: Fabric Shelter Systems

Category 3: Large Structures



3001

Nelson Mandela Bay Multipurpose Stadium

Entrant: MakMax Australia - Designer
 Location: Prince Alfred Park, Port Elizabeth South Africa
 Client: Nelson Mandela Metropolitan Municipality
 Architect: GMP Architects
 Struct. Eng.: MakMax Australia
 Others: MakMax (Installation)
 Builder: Grinaker / Interbeton JV
 Fabricator: MakMax Australia



3022

Rio Tinto Stadium

Entrant: Structurflex Ltd
 Location: Sandy - Salt Lake City Utah USA
 Client: Salt Lake County - Utah & Real Salt Lake
 Architect: Rossetti Architects
 Struct. Eng.: Wade Design Engineers & Wayne Rendely PE
 Builder: Turner Construction
 Fabricator: Structurflex



3066

Skilled Stadium, Gold Coast

Entrant: Tensys Engineering Pty Ltd
 Location: Robina, Qld.
 Client: The State of Qld. Major Sport Facilities Auth.
 Architect: Populous (formerly HOK SVE)
 Struct. Eng.: SKM
 Specialist: Tensys Engineering Pty Ltd
 Others: Beenleigh Steel Fabrications Pty Ltd
 Builder: Watpac Limited
 Fabricator: Hightex GmBh



3120

Greenslopes Private Hospital Car Park

Entrant: Architectural Sails (Qld) Pty Ltd - Contractor
 Location: Lot 108 Nicholson St - Greenslopes Qld
 Client: Ramsey Health Care
 Architect: Phillips Smith Conwell Architects Pty Ltd
 Struct. Eng.: Bligh Tanner & Wade Design Engineers
 Others: Ozrig Pty Ltd (Installation)
 Builder: John Holland Pty Ltd
 Fabricator: Ruffles Engineering & Atkins Fabrication

Category 3: Large Structures Cont.



Mumbai Arrival Plaza

Entrant: MakMax Australia – Designer
Location: Mumbai International Airport – India
Client: Mumbai International Airport Limited
Architect: Designcell
Struct. Eng.: MakMax Australia
Others: Mahimtura Consultants
Builder: Mumbai International Airport Limited
Fabricator: MakMax Australia



ASU – Skysong

Entrant: Atkins Fabrication (Aust) Pty Ltd – Fabricator
Location: Arizona State University – USA
Client: USA Shade & Fabric Structures Inc.
Struct. Eng.: Wade Engineers
Fabricator: Atkins Fabrication (Australia) Pty Ltd



Brisbane State Tennis Outdoor Courts

Entrant: UFS Australasia Pty Ltd
Location: 190 King Arthur Terrace - Tennyson
Client: Mirvac
Architect: Mirvac Design
Struct. Eng.: Wade Consulting
Specialist: Steel Structures Australia
Builder: Universal Fabric Structures / Ozrig
Fabricator: Skyspan Asia

Category 4: Special Applications

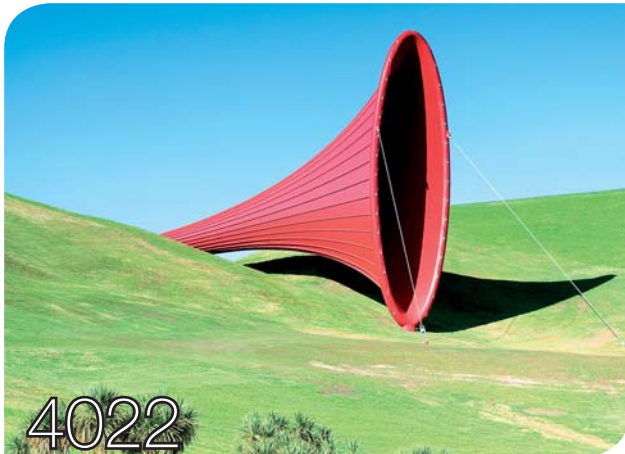

The Farm - Anish Kapoor

Entrant: Structurflex Ltd
 Location: Kaipara Harbour
 Client: Keystone Trust
 Architect: Noel Lane Architects
 Struct. Eng.: Structure Design & CompuSoft Engineering
 Builder: Grayson Engineering
 Fabricator: Structurflex



Whitten Oval

Entrant: Ronstan – Contractors
 Location: Barkley St, Footscray Vic
 Client: Western Bulldogs, Whitten Oval
 Architect: Peddle Thorp
 Struct. Eng.: Irwin Consultants
 Builder: Salta
 Fabricator: Ronstan

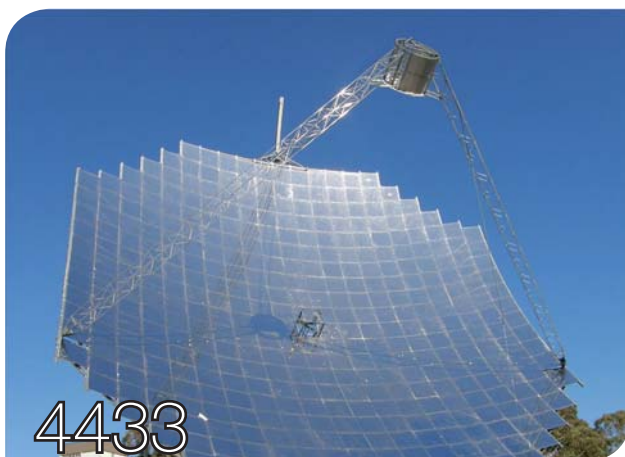

SG4 500m² Big Dish Solar Concentrator

Entrant: Solar Thermal Group - Designer / Fabricator
 Location: Garran Road - Acton Canberra ACT
 Client: ANU / Wizard Power
 Struct. Eng.: ANU Solar Thermal Group
 Fabricator: ANU Solar Thermal Group & Austec Engineering



Green Void

Entrant: MakMax Australia – Designer
 Location: 31 Alfred Street - Sydney NSW 2000
 Client: City of Sydney
 Architect: LAVA (Laboratory of Visionary Architecture)
 Struct. Eng.: MakMax Australia
 Others: MakMax (Installation)
 Fabricator: MakMax Australia

Category 4: Special Applications Cont



RAIA Bar

Entrant: MakMax Australia – Designer
Location: Melbourne Convention & Exhibition Centre
Client: The Australian Institute of Architects
Architect: LAVA
Struct. Eng.: MakMax Australia
Others: MakMax (Installation)
Fabricator: MakMax Australia



Surry Hills Community Centre

Entrant: Aurecon - Sydney – Designer
Location: 405 Crown Street - Surry Hills NSW
Client: Austress Freyssinet
Architect: FJMT
Struct. Eng.: Aurecon - Facade Engineer
Others: Taylor Thomson Whitting - Concept Design
Builder: Austress Freyssinet / Probuild



Tweed Regional Aquatic Centre - Suspended Ceiling

Entrant: UFS Australasia Pty Ltd - Designer
Location: Murwillumbah - Northern NSW
Client: Multispan Australia Pty Ltd
Struct. Eng.: Ferrari Proprietary System
Builder: Universal Fabric Structures / Ozrig
Fabricator: Fabric Shelter Systems

2009 Awards of Excellence

Large Structures - MakMax Nelson Mandela Bay Multipurpose Stadium

"A brilliant modest design for a canopy around a 48k seat stadium. Will help the atmosphere (noise) and allow some light to relieve the shaded side of the pitch."

"The outstanding entry in this category and deserving of the name given."



Medium Structures - MakMax Point Boston Peninsular Club, Port Lincoln

"An example of fabric used as the roof of a building. Good design that worked well with the wall elements and the surrounding shade canopies. Looks a great place for a drink."

"A rare successful integration of a membrane structure with an entire building."



Small Structures - MakMax Yatala Tank Cover

"A good industrial application of fabric. Nicely designed and detailed with considerable difficulty caused by the rotation of the whole roof unit."

"A very well designed and executed solution for a challenging application."



Special Applications

Structurflex NZ The Farm - Anish Kapoor

"A marvelous giant sculpture brilliantly located in the landscape. Excellently engineered and detailed to achieve a magical result"

"Excellent example of membrane structure art and it's integration with the landscape."



Solar Thermal Group ANU SG4 500sqm Big Dish Solar Concentrator

"A brilliant piece of product engineering design using lightweight principles for solar energy conversion. Hopefully we will see more of these in the landscape producing clean power."

"Outstanding prototype providing an exemplary solution to a pressing contemporary renewable energy issue."

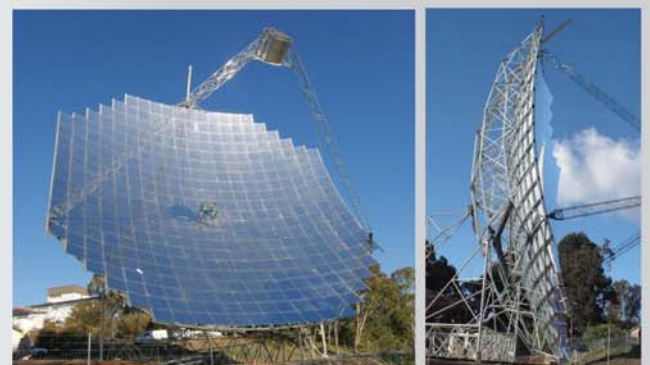

LSAA 2007 Images

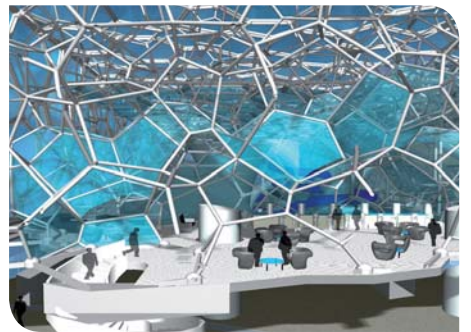
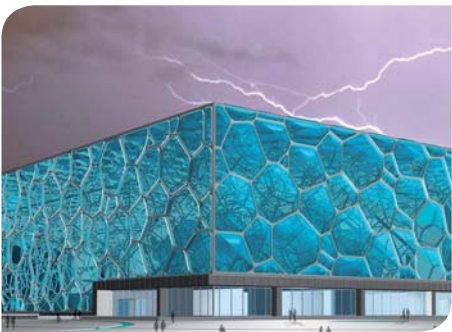

LSAA 2002 Images

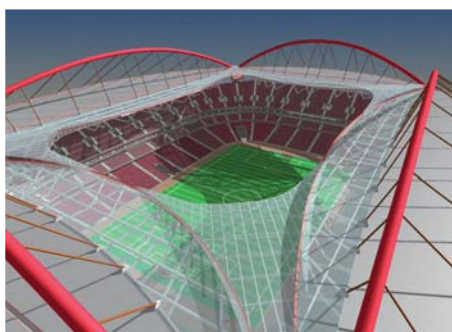
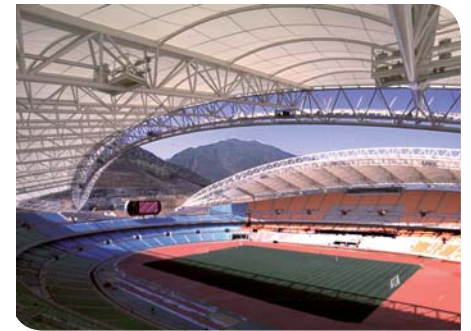

LSAA

LIGHTWEIGHT STRUCTURES ASSOCIATION OF AUSTRALASIA INC.

w: www.lsaa.org

