

Taronga Zoo Chimpanzee Separation Enclosure



Rowan Murray & Sascha Humphreys
LSAA 2011, Sydney

www.RonstanTensileArch.com

1

Existing Chimpanzee Exhibit

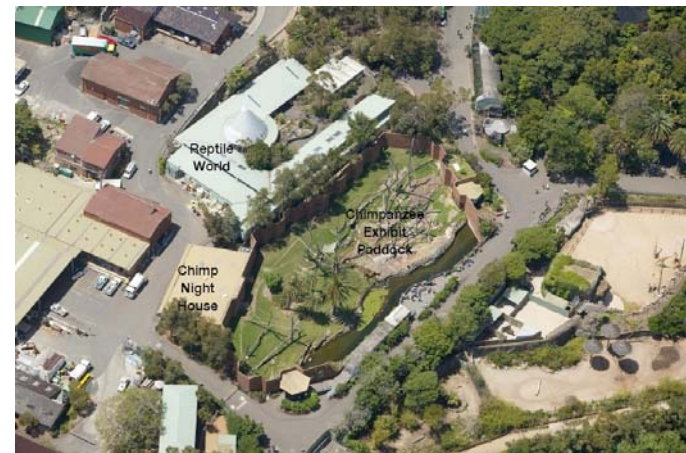

www.RonstanTensileArch.com

Design Issues/Response – Views from the Harbour



www.RonstanTensileArch.com

Design Issues/Response - Built Form



www.RonstanTensileArch.com

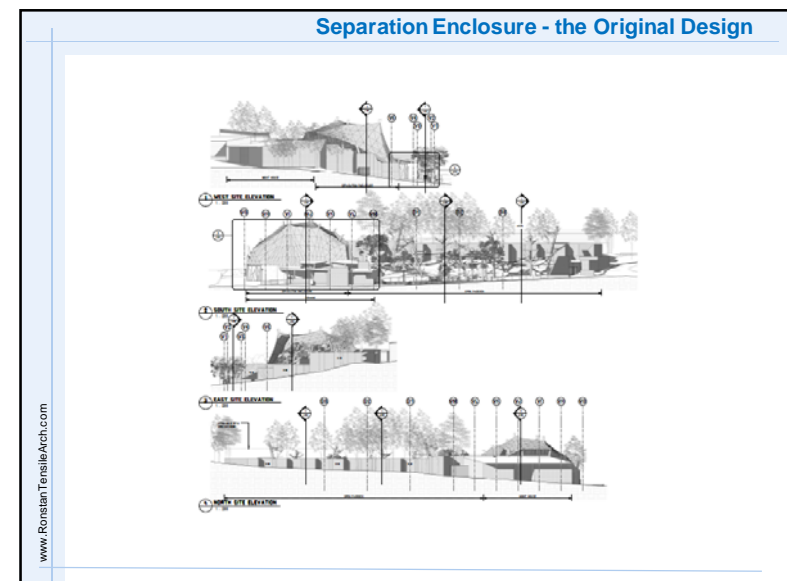
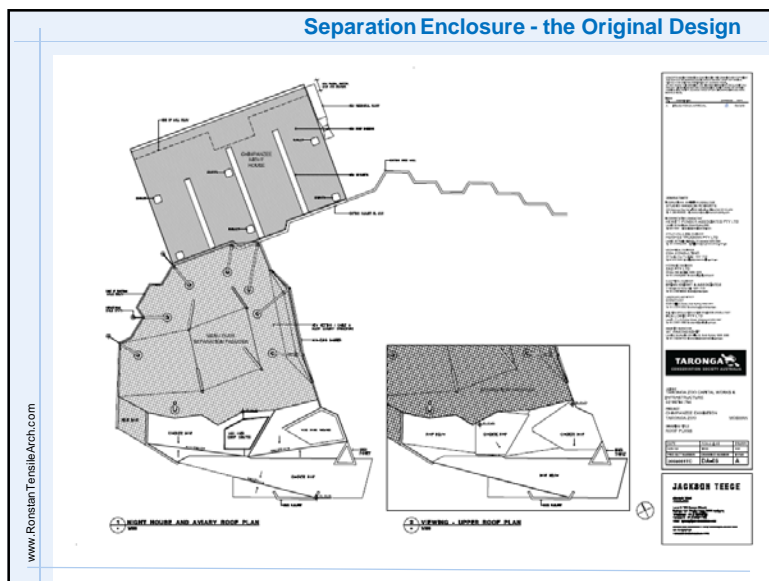
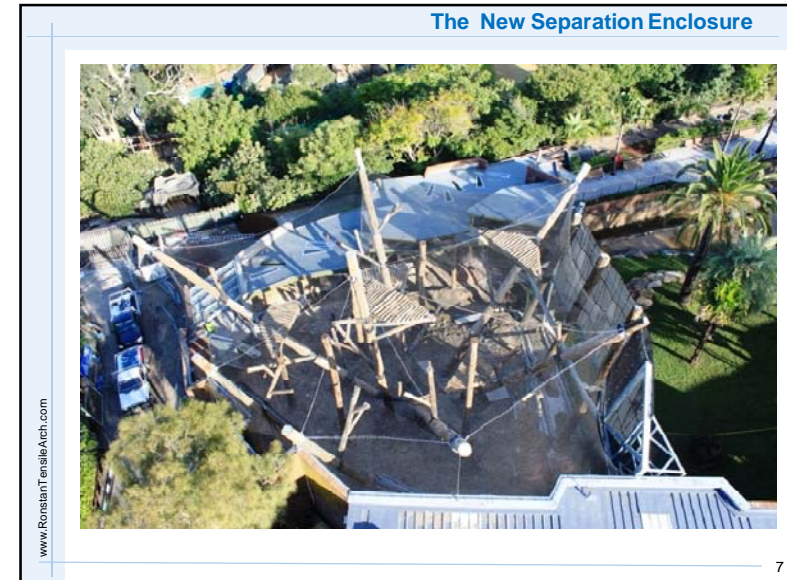

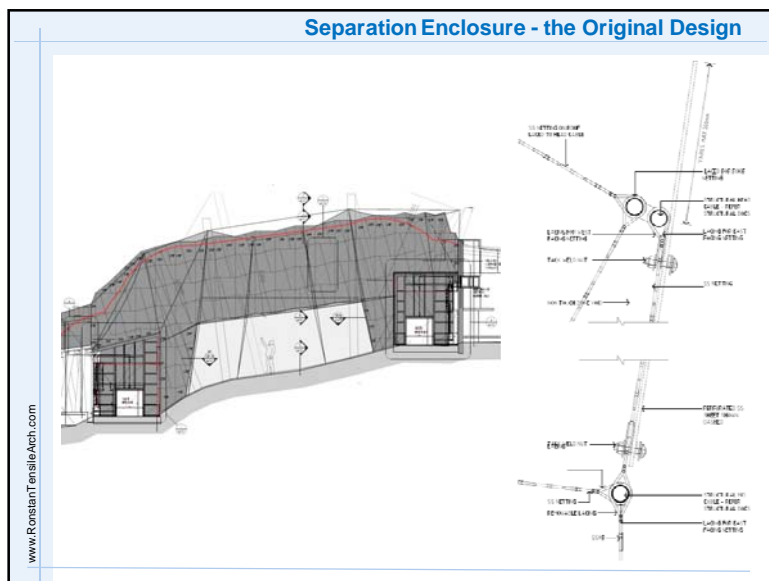
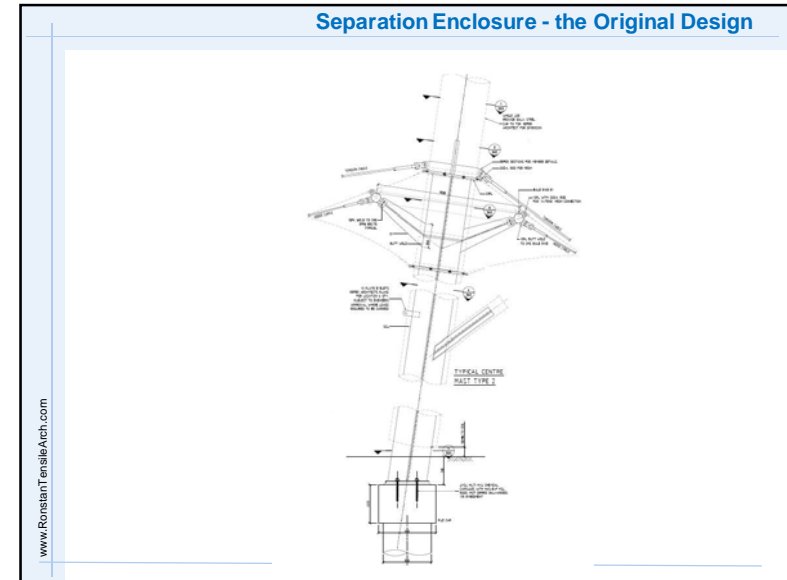
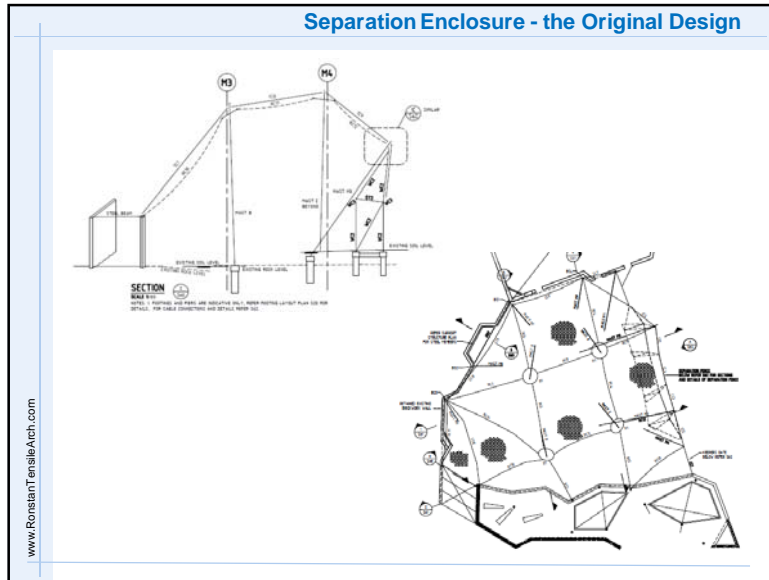

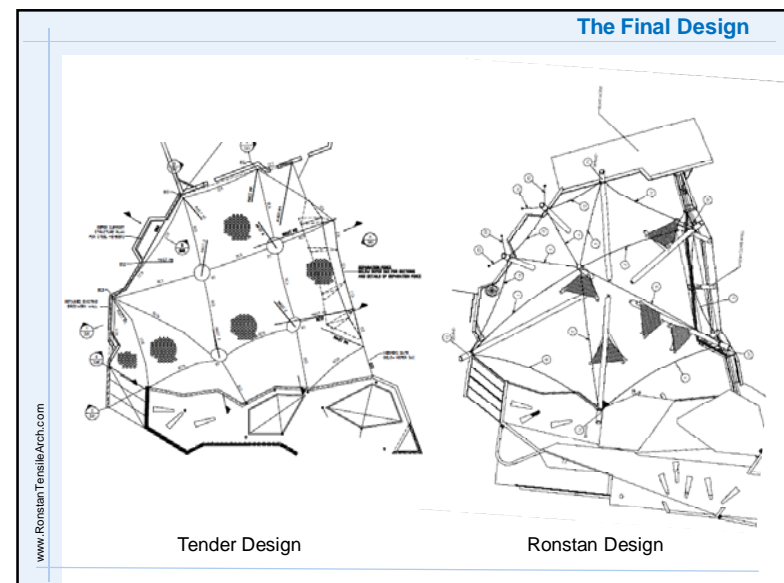

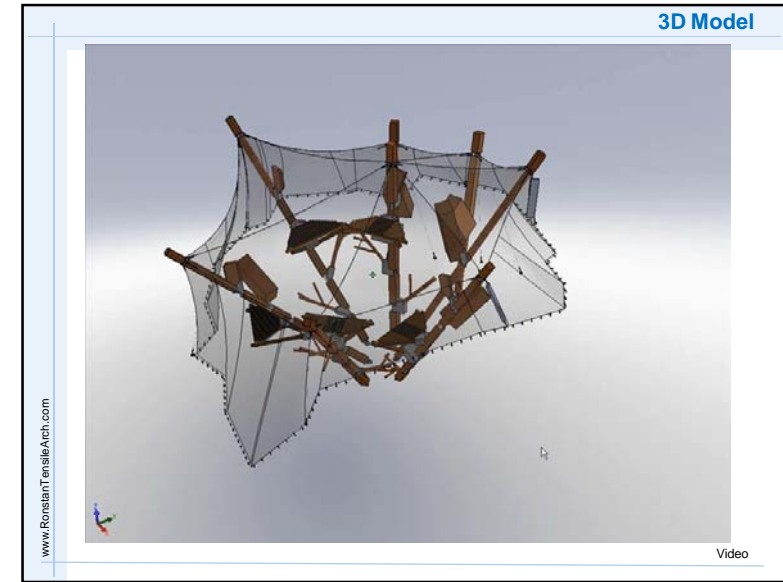
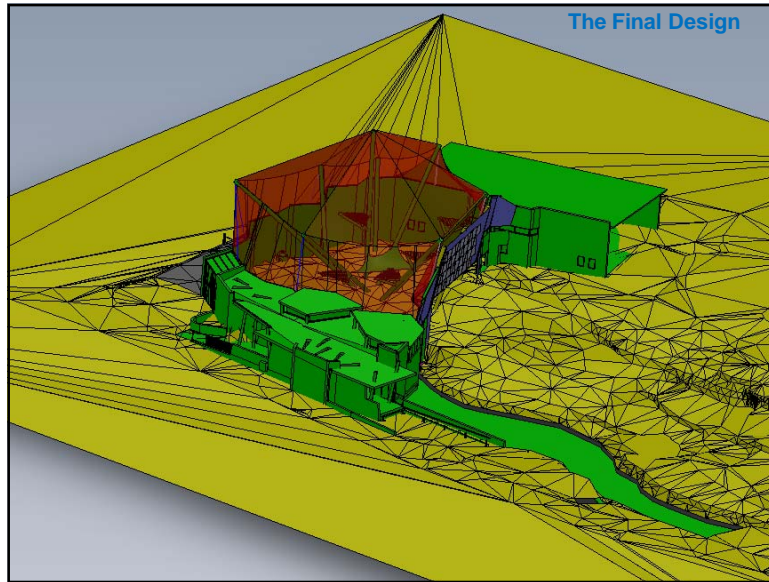

Relationships & Collaboration

- Communication Tools
- Collaborative Software
- Physical Tools

www.RonstanTensileArch.com

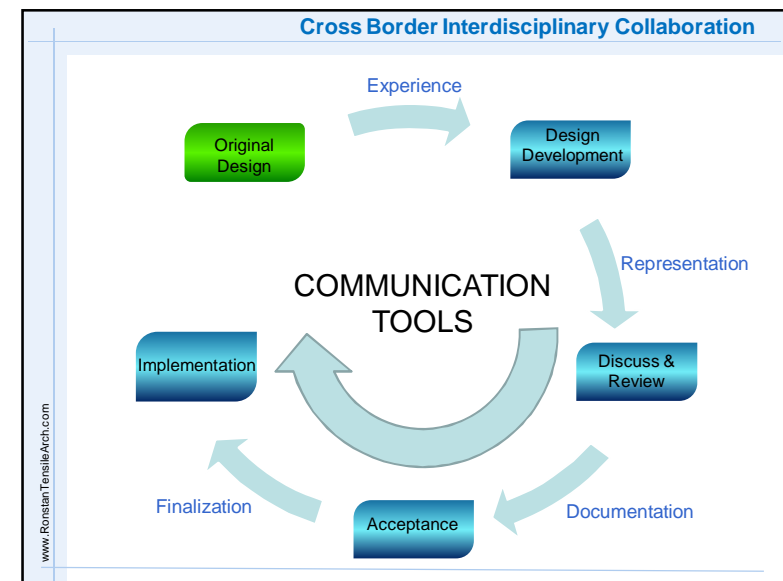

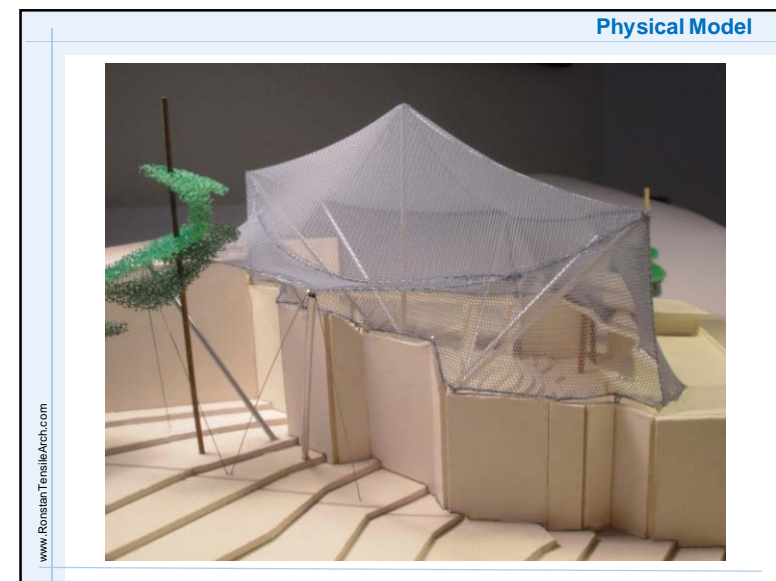
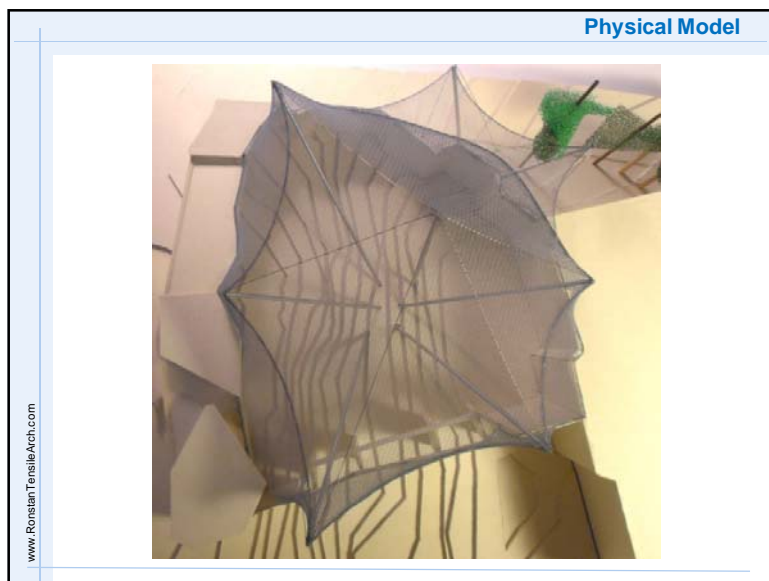
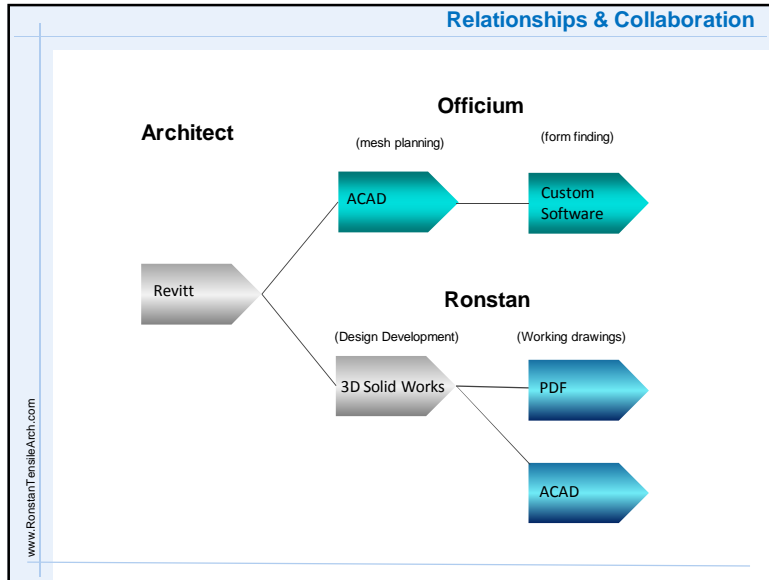

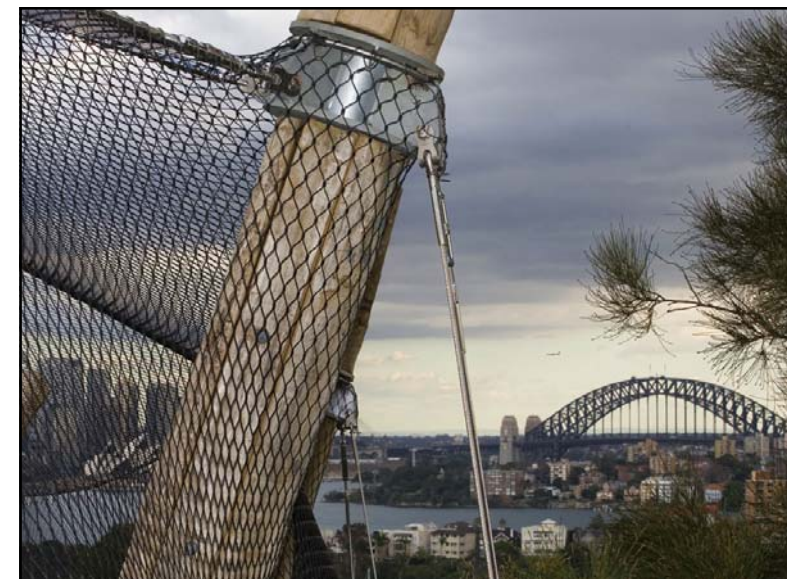
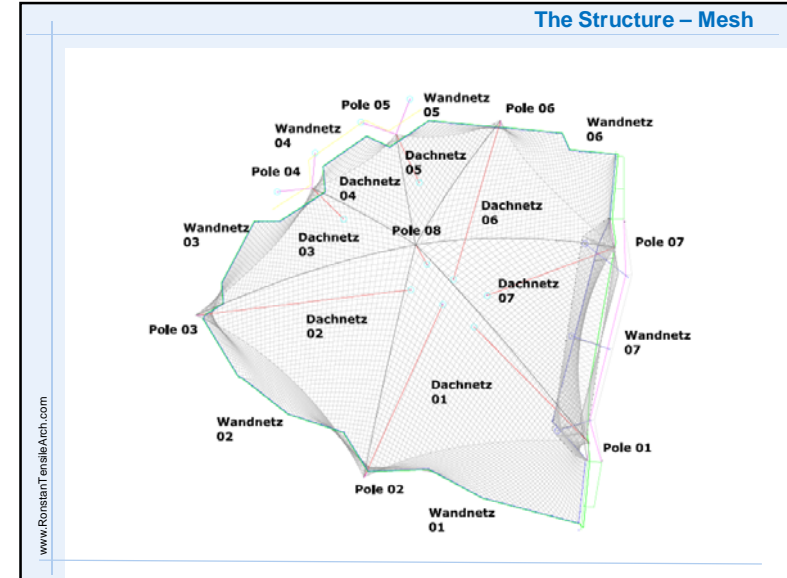
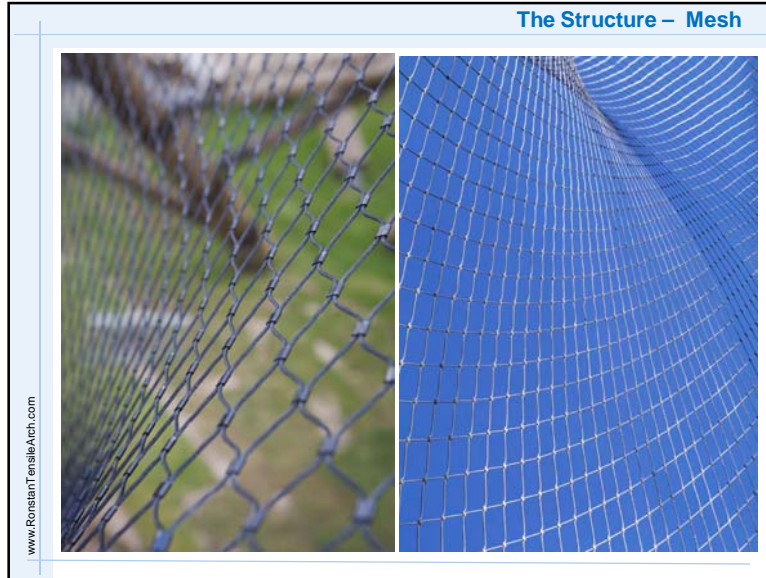

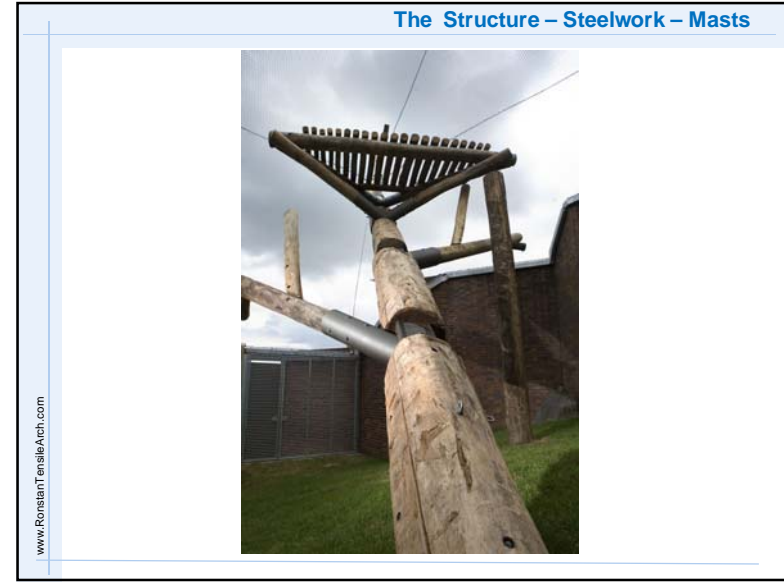

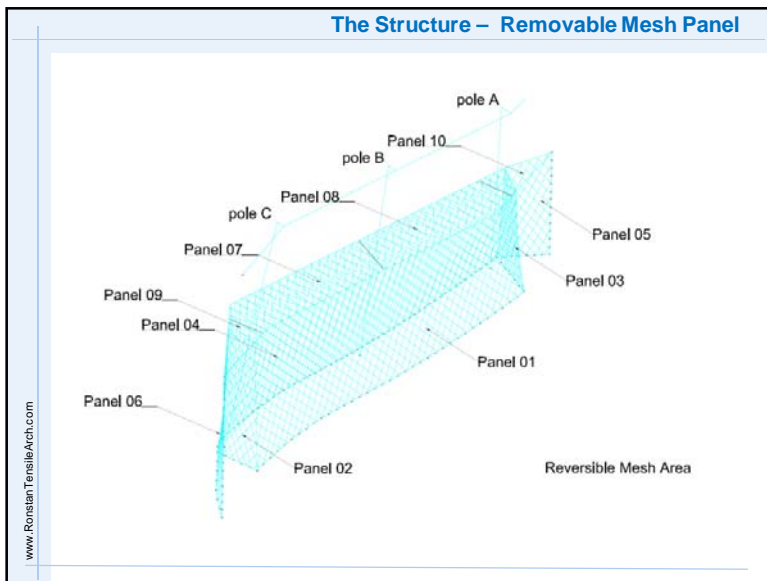
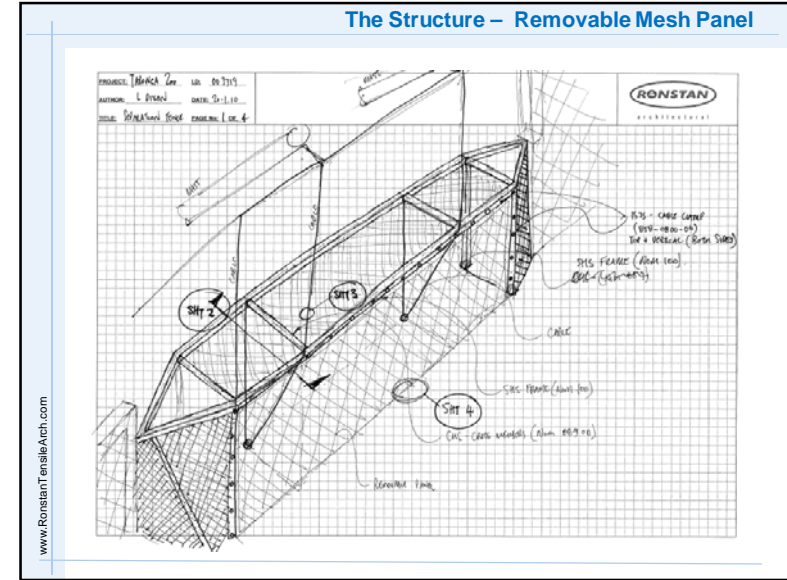

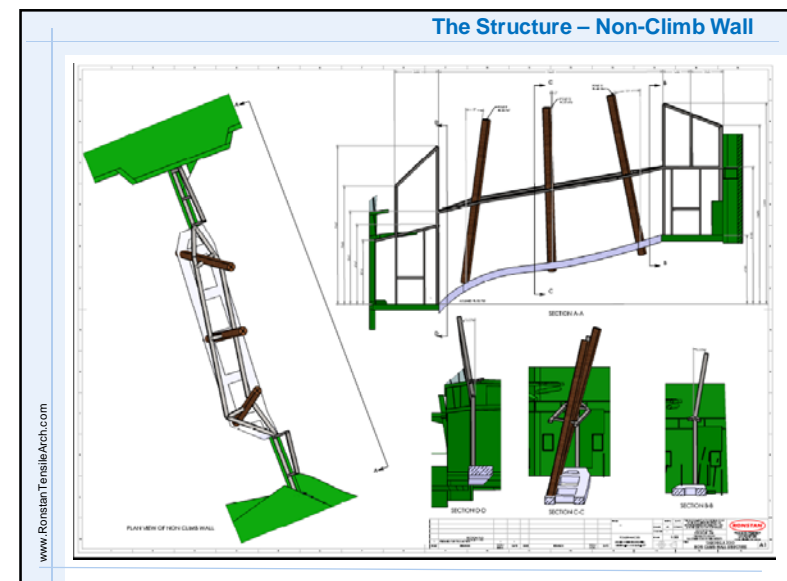
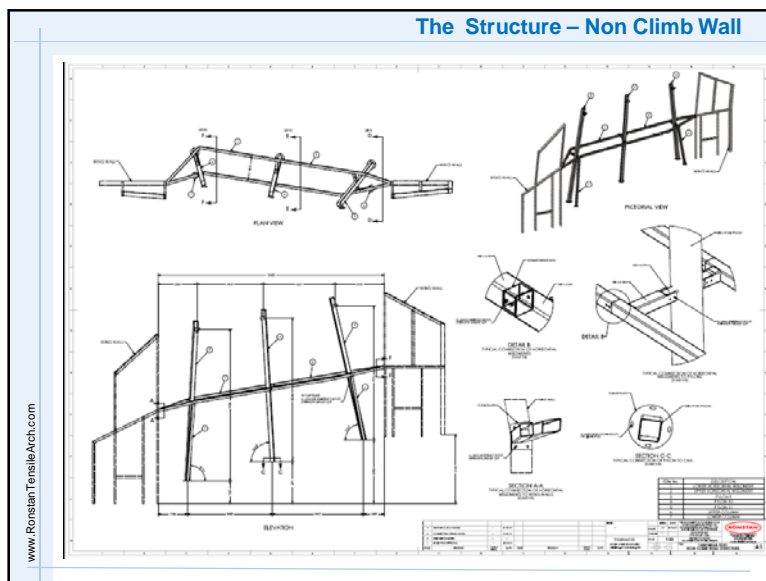
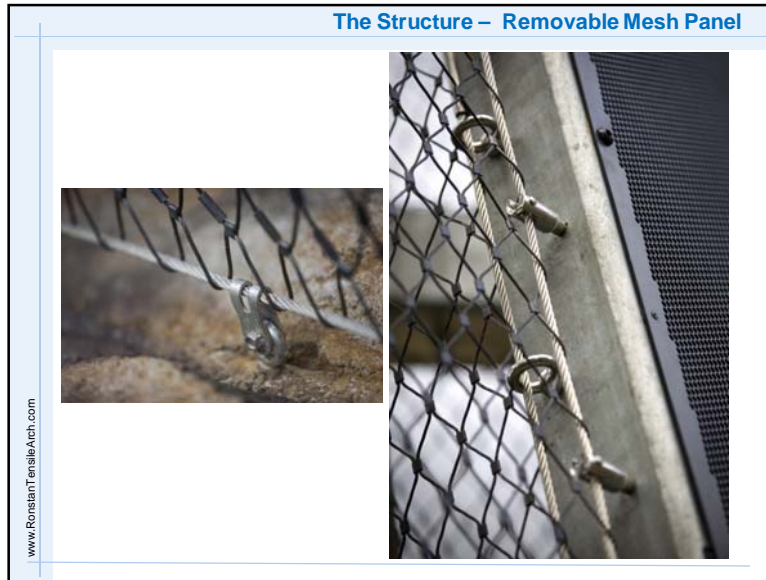

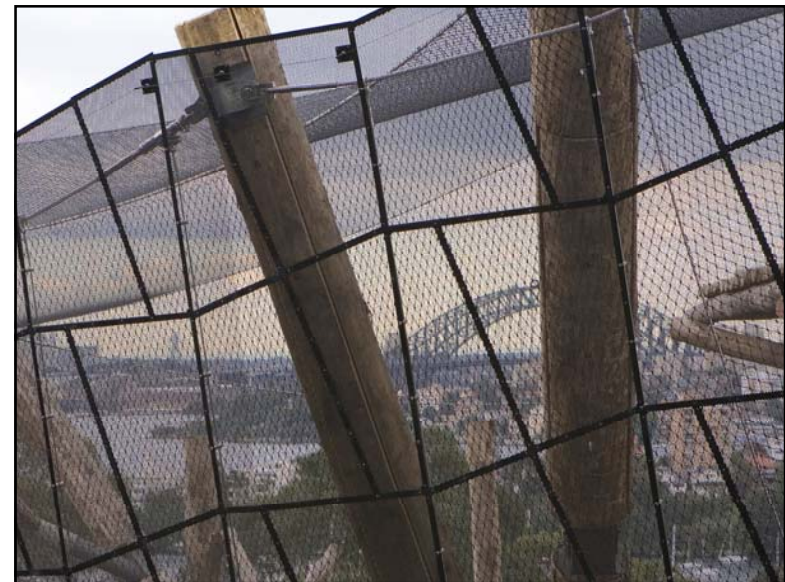
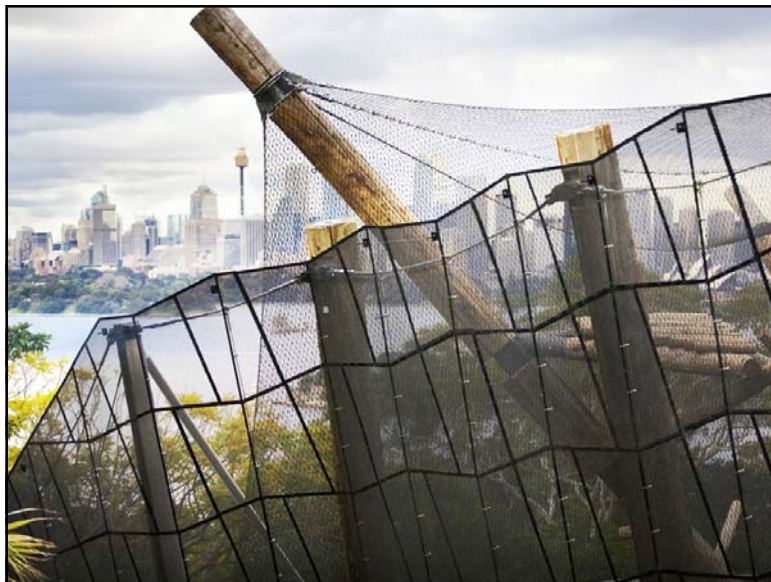

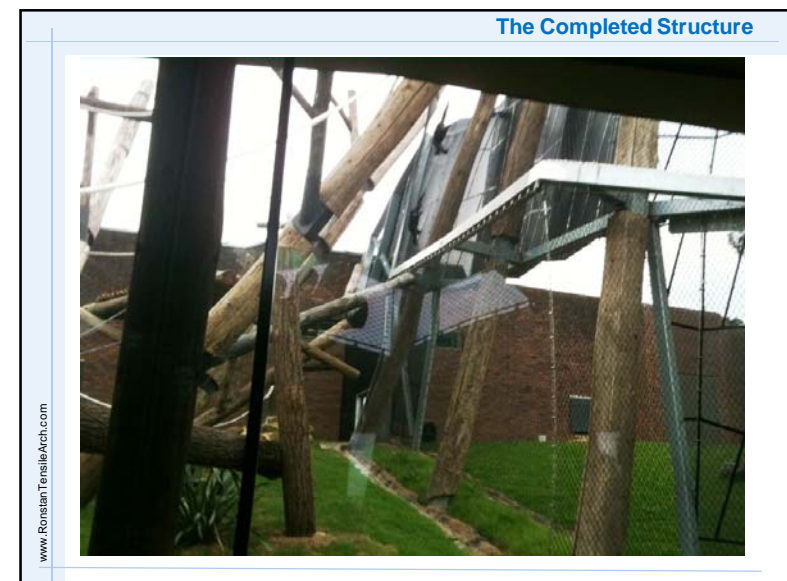
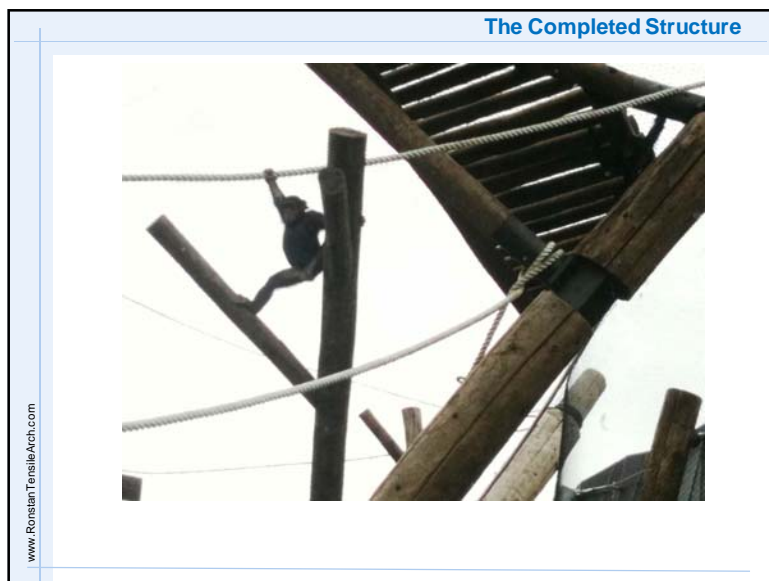
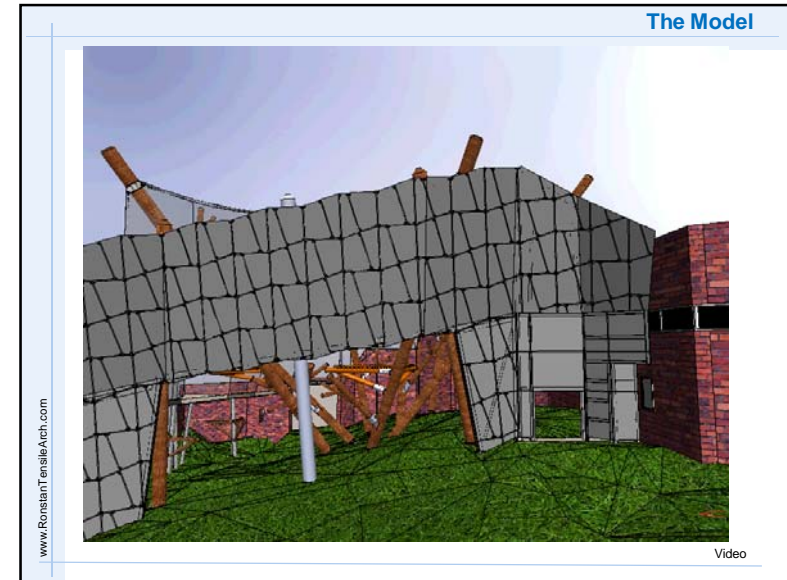
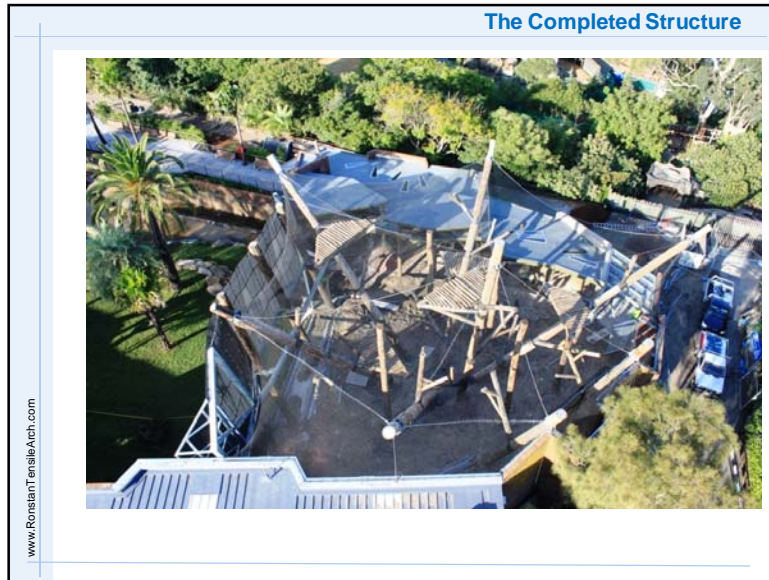



Thank you

<u>Project Client:</u>	Taronga Conservation Society Aust.
<u>Project Architect:</u>	Jackson Teese Architecture
<u>Project Engineer:</u>	Hughes Trueman
<u>Building Contractor:</u>	Lipman Pty. Ltd.
<u>Specialist Contractor /Enclosure :</u>	Ronstan Tensile Architecture
<u>Specialist Engineer/Enclosure/NCW:</u>	Tensys Engineers
<u>Mesh Design/Enclosure:</u>	Officium Design Engineering
<u>Mesh:</u>	Carl Stahl GmbH.

Rowan Murray / Sascha Humphreys
Ronstan Tensile Architecture
Melbourne, Australia

TENSILE ARCHITECTURE

www.RonstanTensileArch.com